



L043-A01



L043-A02

M410 LEGIC L043-A01 / -A02

Operating Instructions

Contents

Page

General description / Technical data / Safety instructions	2
Care and maintenance / Factory settings / Functional description	3
Overview of transponder cards	4
System components / Package contents / Installation	5
Installation variant for internal RFID reader	6
Dimensions.....	7
Getting started and changing batteries / Tips for programming steps	8
Using the installation card / Programming the master card.....	9
Programming the user cards / Closing & opening	10
Unauthorised transponder cards / Facility Manager function / Emergency opening ..	11
Deleting individual transponder cards / Deleting all transponder cards	12
Changing the operating mode	13
Deactivating and activating acoustic signals / Resetting to factory settings.....	14
Activation and Deactivation of automatic locking	15
Activation and deactivation of unlimited shared use / Configure RFID system with LEGIC System Authorization Media (SAM)	16
Remove LEGIC MTSC configuration on RFID system / Battery warning	17
External power supply.....	18
Firmware update / Reordering master cards / Troubleshooting	19

GENERAL DESCRIPTION

The M410 LEGIC L043-A01 / -A02 locking system is an electronic furniture lock with a RFID reader. The system is intended for indoor use in the home and office. Using the system in applications for which it is not intended may result in irreparable damage to it and render any claims null and void. These operating instructions provide information how to properly install and operate the locking system.

Please be sure to observe all warnings and read the operating instructions completely before proceeding with installation, commissioning and programming.

It may be possible to use our locks and locking systems together with mechanisms made by other manufacturers, but their compatibility must be checked in each individual case. We cannot accept any liability for damage or loss due to incompatibility.

Wording and graphics have been prepared with care. However, no liability will be assumed for any mistakes that may have occurred. Technical specifications as well as the scope of items in the system are subject to change without notice.

CAUTION: The locking system can be configured with master and programming cards or with the LEHMANN Management Software LMS. These operating instructions describe how to use the locking system with master and programming cards. The software LMS and the corresponding documents can be found at <https://lms.lehmann-locks.com>.

TECHNICAL SPECIFICATIONS

Frequency	13.56 MHz National legislation about permissible radio frequencies must be observed.
RFID technology	LEGIC prime, LEGIC advant, MIFARE® Classic, MIFARE® DESFire® EV1, EV2 HID iClass Transponder App only with master cards (no LMS) from firmware version 2.x. Locks with LEGIC master tokens do not support smartphones.
Supported transponders	Compatible with the following RFID transponder cards: LEGIC: ATC256-MV410, ATC1024-MV010, CTC4096-MP410, ATC1024-MV110, ATC4096-MP311, ATC4096-MP312, CTC4096-MM410, MIM1024-MN MIFARE® Classic, MIFARE® DESFire®, ISO 14443A Existing transponders must be checked for compatibility and reading distance. MIFARE® Classic and LEGIC prime transponders are only supported in „Assigned use“ mode. MIFARE® Classic and LEGIC prime transponders cannot be used with the LMS.
Energy supply	1 battery in the lock (type CR123A)
Operating temperature	-5°C - +60°C
Storage temperature	-25°C - +70°C
Type designation	Lock M410: SLIICBM6 L043-A01: L1LA13MX L043-A02: L2LA13MX

SAFETY PRECAUTIONS

- When replacing the battery, make sure that the polarity and position of the battery is correct!
- Dispose of used batteries properly!
- Do not heat batteries, take them apart or short-circuit them!
- Never throw batteries into open fire!

- The battery must not be charged!
- Keep the product away from children, as small parts may be swallowed!
- Any persons swallowing batteries must seek immediate medical advice!
- Damaged and/or leaking batteries may cause acid burns and/or poisoning!

CARE AND MAINTENANCE

- Do not spill any liquid over or into the individual components of the system, and never immerse the components in any liquid.
- The product should not be exposed to direct sunlight.
- Clean the system with a clean, soft, damp cloth only.
- Do not use any cleaning agents containing abrasives or solvents, as these may damage the housing.
- Treating any of the electronic and mechanical components improperly or in any way other than described in these operating instructions may lead to malfunctions and the loss of warranty.

FACTORY SETTINGS

The system can be closed and opened at this point of time with one or more installation cards. You have the option of changing the operating mode (see Changing the operating mode, P. 13).

FUNCTIONAL DESCRIPTION

This locking system is a compact, battery-powered furniture lock for different applications in the home and office. Opening and closing are powered by an electric motor. Contactless RFID technology based on 13.56 MHz is used as a “key”.

Two operating modes are available:

Lock operating mode	Description
Assigned use (factory settings)	There is a fixed assignment between the transponder cards and the locks. The user cards are programmed or deactivated at the lock by means of a master card. The system thus allows the granting of selective access authority for an item of furniture (e.g. cabinet), so that only authorised persons with a transponder card have access. A transponder card can be programmed simultaneously on multiple locks with “Assigned use” operating mode. Up to 50 different transponder cards can be programmed per lock.
Shared use	With the user card, a user can use a free lock / storage of his choice. It is not possible to program the user card using the master card. If a lock is closed with the user card, the user card and the furniture lock are coupled to each other. The card cannot be used at any other lock in “shared use” mode, and the lock will not accept any other user card. This coupling is only deactivated when the user opens the lock again with his user card. The card can now be used for another lock.

In order to use the operating mode “shared use” with LEGIC advant transponders, the RFID system must be configured with LEGIC System Authorization Media (SAM), (see Configure RFID System with LEGIC System Authorization Media (SAM), P. 15). LEGIC prime transponders are only supported in the mode “assigned use” without LEGIC stamp on the RFID system.

Only the M410 LEGIC L043-A02 with a spacer is suitable for use on metallic surfaces.

Please note that the distance between two or more RFID readers must be at least 5 cm.

This system is not intended for „push-to-open“ applications. If required, this needs to be tested on individual basis.

OVERVIEW OF TRANSPONDER CARDS

Card type	Description
Installation card (only for assembly and testing purposes)	The installation card can be used specially for assembly and testing purposes in order to perform basic functions on the lock (opening and closing). Furthermore, the lock can be closed using the installation card for transporting the furniture to its destination. This card is for universal use. Any number of installation cards can be used at any lock. Prior programming of a master card is not necessary. After a master card has been programmed for the first time, the lock is disabled for the installation card. The use of an installation card is optional.
Master card	For complete commissioning, a master card must be programmed for both operating modes. The master card is required for starting and terminating programming operations. This also includes the programming of user cards in "Assigned use" mode. The master card also enables the so-called Facility Manager function and the emergency opening of the lock. A maximum of one master card can be programmed per lock. You can use one master card for several locks.
User card	User cards are used to open and close the lock. In "Assigned use" mode, up to 50 user cards can be programmed on one lock. In "Shared use" mode, one user card can be used temporarily on one lock. It is possible to program one user card on several locks in "Assigned use" mode, and at the same time on one lock in "Shared use" mode.
Programming card set	For certain programming functions, programming cards are required in conjunction with the master card. The programming card set consists of 3 universal programming cards: <ul style="list-style-type: none"> • P1: Mode (change of mode) • P2: Sound (activating or deactivating acoustic signals) • P3: Reset (reset to factory settings)
Programming card „P4: Auto Locking“	The universal programming card „P4: Auto Locking“ can only be used in the operating mode „assigned use“. The function can be activated together with the master card. After opening the lock with a programmed transponder in the operating mode „assigned use“, the lock closes automatically after 5 seconds once this function has been activated. This function is only suitable for locks with a spring loaded bolt.
Programming card „P6: Unlimited Shared Use“	The programming card „P6: Unlimited Shared Use“ can be used in the „shared use“ mode. After activation, a RFID transponder can lock several locks at the same time (caution: even up to all locks!), instead of just one lock per transponder in this operating mode.
Update card	In addition to the master card, you will receive an update card. In conjunction with the master card, the update card allows firmware updates to be loaded into this locking system
Service key	In addition to the master card and update card, you will receive a card with an individual service key. Please keep the card with the service key carefully and securely. The printed service key allows you to reorder master cards. It is not possible to reorder a master card without a service key! This card has no electronic function!

As user cards, you can either use LEHMANN user cards or cards of a third-party provider complying with the supported transponders mentioned on page 2 under the technical specifications. Please note the following possible restrictions when using user cards of third-party providers:

- The "Shared use" operating mode is only possible with user cards from third-party providers if they have the appropriate write permission for the user card.
- Transponder cards with a so-called "Random-UID" are not supported.

Transponders from third-party providers must be checked for compatibility and reading distance in advance. For the highest possible level of safety, transponder cards based on LEGIC advant are recommended.

LEGIC prime transponders are usable to limited extent (only in „assigned use“ mode, not with LMS).

Please note that installation cards, master cards, user cards and programming cards must be ordered separately.

Please keep the master and update cards as well as the card with the individual service key carefully and securely!

SYSTEM COMPONENTS / PACKAGE CONTENTS / INSTALLATION

Please note that these operating instructions apply to different product versions. The package content therefore depends on the respective product variant. The product variants and mounting recommendations shown here are intended for wooden furniture with a thickness of 19mm. In the case of deviating thicknesses and materials, the screws for mounting the lock and the RFID reader must be adapted.

Components for M410

1. M410
2. 4x screw (3,5x35) for M410
3. 1x battery (CR123A)
4. Striker plate
5. 3x screw (3x13) for striker plate
6. Cable

Optional components for RFID reader L043-A01

7. RFID reader L043-A01
8. 2x thermoplastic screw (3x20)
9. RFID reader housing for internal mounting
10. 2x screw (3x13) for RFID reader housing
11. Double-sided adhesive tape

Optional components for RFID reader L043-A02

12. RFID reader L043-A02
13. 2x thermoplastic screw (3x20) for mounting the RFID reader L043-A02
14. Spacer
15. 2x thermoplastic screw (3x25) for mounting the RFID reader L043-A02 and the spacer

External RFID reader (L043-A01 / L043-A02)

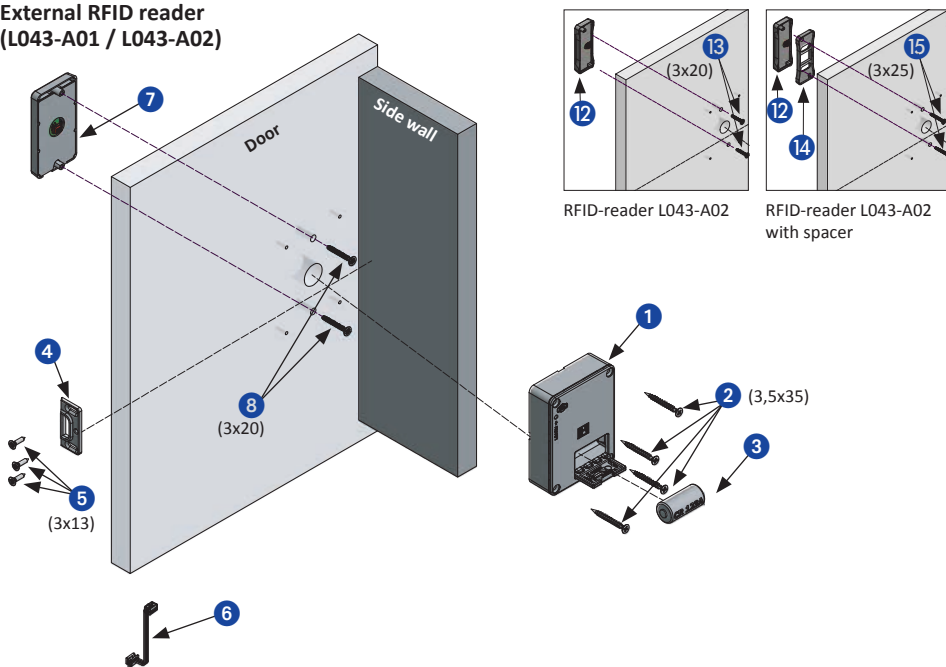

RFID-reader L043-A02

RFID-reader L043-A02 with spacer

! The bolt protector is required for the spring loaded bolt version.

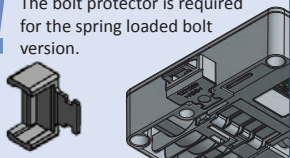

! Attach the RFID reader with the thermoplastic screws 3x20.

Use the thermoplastic screws 3x25 only for the RFID reader with additional spacer (see above).

Please note the different mounting positions and drilling pattern for the RFID readers.

M410

RFID reader L043-A01

RFID reader L043-A02
without spacer

RFID reader L043-A02
with spacer

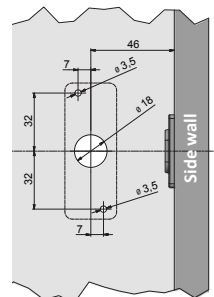
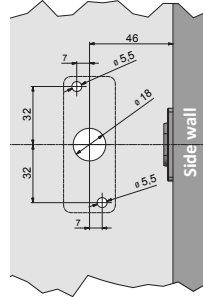
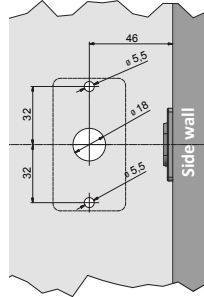
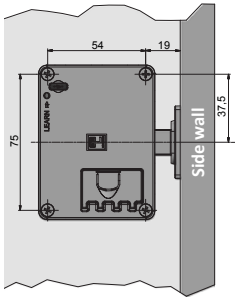

- CAUTION:**
- For mounting the RFID reader L043-A02
 - **without** spacer please use drill holes of 5,5mm.
 - **with** spacer please use drill holes of 3,5mm.
 - Please countersink holes for screwheads.
 - Tighten the screws hand-tight with max. 0.7 Nm.

Internal RFID reader L043-A01 (not possible for metal surfaces)

As an alternative to the standard mounting of the reader unit on the front side of the furniture, the RFID reader L043-A01 can also be mounted on the inside. This is possible up to a wood thickness of max. 19mm. Please note that the reading range between the transponder card and the RFID reader is then limited and light signals are no longer visible. Please also note that an external power supply is only possible with an external RFID reader.

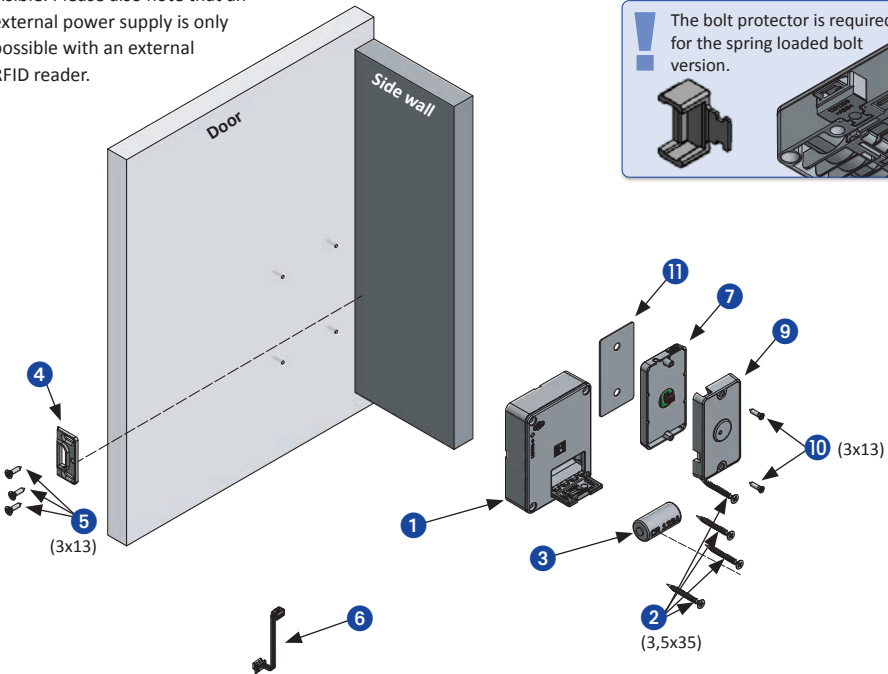
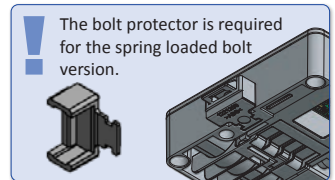

Install the lock as described above and pay attention to the following points:

- 1 Remove the protective film from one side of the adhesive tape and apply the adhesive tape to the front of the RFID reader (LED is covered).
- 2 Connect the optical cable to the RFID reader and route it in the direction of the cable outlet.
- 3 Press the RFID reader and the cover together. Make sure that the cable is not pinched or damaged.
- 4 Tighten the two housing screws by hand and then connect the optical cable to the lock.
- 5 Remove the protective film from the rear side of the adhesive tape.

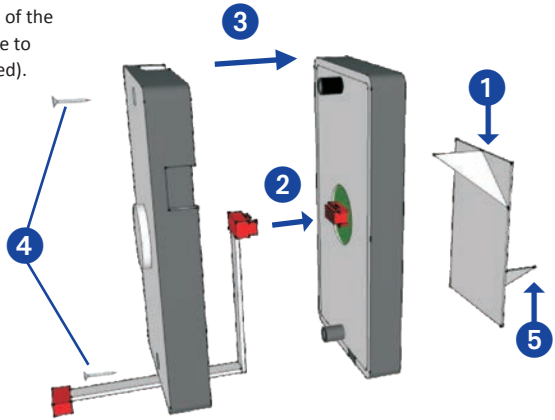

Then stick the entire reading unit to the inner side of the door.

Please position the RFID reader in such a way that you still have access to the micro-USB port.

DIMENSIONS

M410

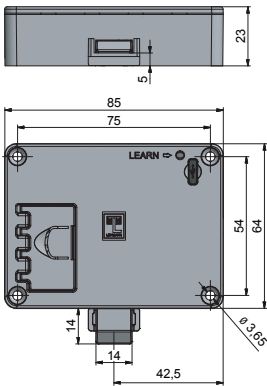

Striker plate

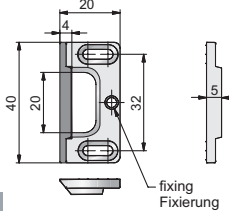

RFID reader L043-A01 (internal mounting)

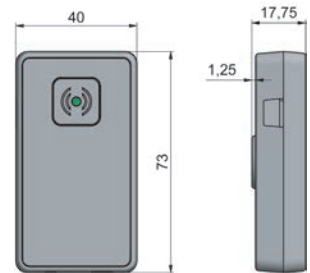

RFID reader L043-A01

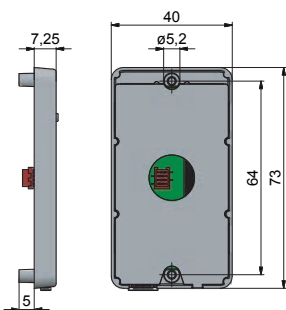

RFID reader L043-A02

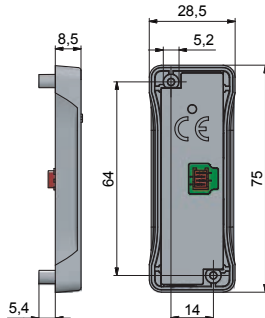

RFID reader L043-A02 with spacer

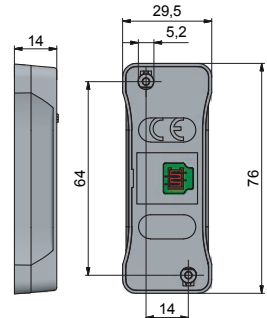

GETTING STARTED AND CHANGING BATTERIES

Make sure that the lock and the RFID reader are correctly connected to each other with the connecting cable. Make sure that the connections between the plugs and sockets are properly aligned.

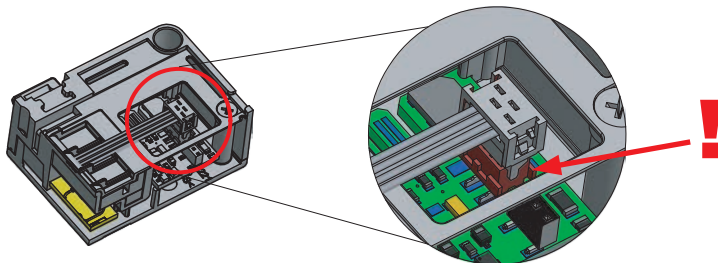

CAUTION: Use only a CR123A primary-battery.

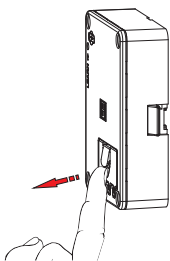

Open the battery compartment as shown above.

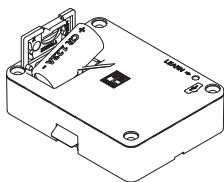

Insert the battery first with the minus pole as shown above. The battery is placed on the battery removal tape so that the tape tip protrudes.

To remove the battery, pull on the battery removal tape.

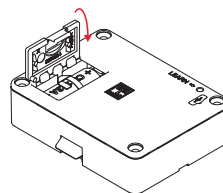

Close the battery compartment with the tape inserted.

Inserting the battery

Initialisation takes place. During initialisation, no transponders should be placed within the read range of the RFID reader.



Program the lock in accordance with these operating instructions. Once the programming operation is completed, ensure that the system is functioning correctly.



TIPS FOR THE FOLLOWING PROGRAMMING STEPS

The last 5 seconds before the shutdown of the programming process are announced by the flashing of a yellow lamp and acoustic signals. The visual and acoustic signals are differentiated as follows

Optical signals

-  Short flashing
-  Long flashing

Acoustic signals

-  Short
-  Long

USING THE INSTALLATION CARD (optional)

During installation, one or more installation cards can be used. The installation cards are ready for immediate use and do not have to be programmed. With the installation cards, the basic functions (opening and closing) can be carried out on the lock. It is not possible to program user cards with the installation card. The installation card can no longer be used on a lock as soon as the master card has been programmed.

Closing

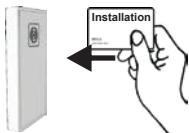

Hold the installation card in front of the reader.



Opening

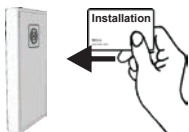

Hold the installation card in front of the reader.



PROGRAMMING THE MASTER CARD

Irrespective of the desired operating mode, a master card must always be programmed before further programming and operation. Only one master card can be programmed per lock! The programming of the master card can be carried out when the lock is closed as well as when it is open. If the lock is closed after the master card has been programmed, the next step must be an emergency opening (see Emergency opening, P. 11).

Programming the master card for the first time

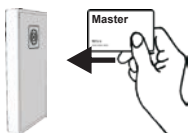

Hold the master card in front of the reader.







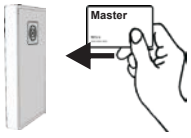

OPERATING MODE

The locking system is in „assigned use“ mode after the master card has been programmed. If you would like to use the lock in “Shared use“ mode, the next thing to do is to change the operating mode. To do this, please follow the instructions on page 13 and then continue with the section “Closing and Opening“ on page 10.

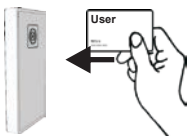

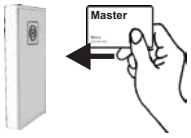

PROGRAMMING THE USER CARDS (only for "Assigned use" mode)

In "Assigned use" mode, a maximum of 50 different user cards can be programmed per lock. It is not possible to program user cards in "Shared use" mode. In "Shared use" mode, the lock can be opened and closed without first programming the user cards (see Closing and Opening, P. 10).

Programming user cards	
 <p>Hold the master card in front of the reader.</p>	
 <p>Hold the user card in front of the reader. The card is accepted and programmed. This process can be repeated to program multiple user cards.</p> <p>Card is not accepted.</p>	 
 <p>Hold the master card in front of the reader.</p>	

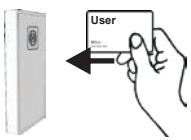
After programming, the user cards can open and close the lock.

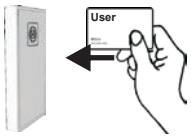
CLOSING AND OPENING

Closing	
 <p>Hold the user card in front of the reader.</p>	
Opening	
 <p>Hold the user card in front of the reader.</p>	

UNAUTHORISED TRANSPONDER CARDS

Rejection of an unauthorised user card

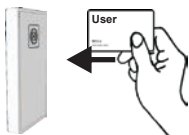

Unauthorised user card is held in front of the reader. The card is rejected.



FACILITY MANAGER FUNCTION

In the event that an authorised person only briefly wants to check whether for example a cabinet is actually occupied, the lock can be opened with the master card. With this function, the lock opens for 30 seconds and then closes automatically. After this automatic closure, authorised user cards can continue to be used in “Shared use” mode as well as in “Assigned use” mode.

Facility Manager Function (lock closes automatically after 30 seconds)

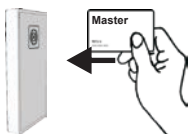

Hold the master card in front of the reader.



EMERGENCY OPENING

In the event that one or all authorised user cards are currently not available, an emergency opening can be effected with the master card. Please note that the lock remains open after emergency opening. In the “Shared use” mode, the previously used user card is blocked after emergency opening, and can no longer be used. In “Assigned use” mode, user cards can continue to be used normally.

Emergency opening

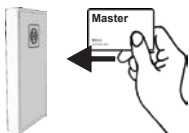

Hold the master card in front of the reader.

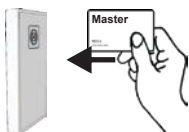







Hold the master card in front of the reader.

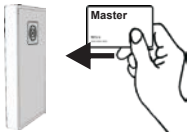

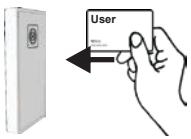
DELETING INDIVIDUAL TRANSPONDER CARDS (only for "Assigned use" mode)

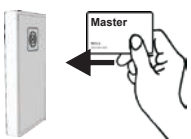

Insofar as further user cards were programmed on the lock, these can continue to be used on this lock after an individual user card has been deleted. For the deleting process, the lock must be open. To do this, first carry out an emergency opening with the master card if necessary (see Emergency opening, P. 11).



Deleting individual user cards	
 <p>Hold the master card in front of the reader</p>	
 <p>Hold the user card to be deleted in front of the reader.</p>	
 <p>Hold the master card in front of the reader.</p>	

Should the user card be lost, then please proceed as follows.

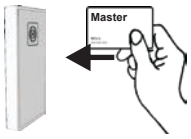
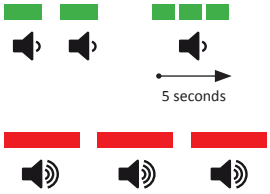
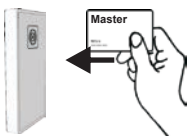
DELETING ALL TRANSPONDER CARDS (only for "Assigned use" mode)

The deleting process can only be carried out when the lock is open. Should there be no authorised user card to hand, first perform an emergency opening using the master card.

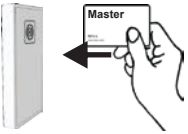





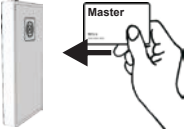

Deleting all user cards	
 <p>IMPORTANT: Hold the master card in front of the reader until all the following optical and acoustic signals have been received.</p>	
 <p>IMPORTANT: Hold the master card in front of the reader until all the following optical and acoustic signals have been received.</p>	

 <p>Hold the master card in front of the reader.</p>	
---------------------------------------------------------------------------------------------------------------------------------------	-----------------------------------------------------------------------------------

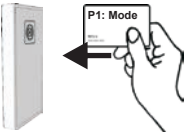
CHANGING THE OPERATING MODE

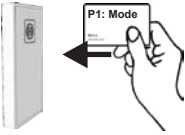
The lock has two modes: “Assigned use” and “Shared use”.

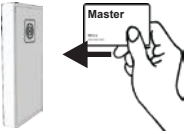
When the lock is open, you have the option of changing the mode. To do this, the master card and the programming card No. 1 (P1: Mode) are required. The programming card set must be bought separately from LEHMANN Vertriebsgesellschaft mbH & Co. KG. The cards are for universal use.







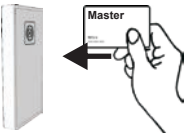

Changing the operating mode		
 <p>Hold the master card in front of the reader.</p>		
 <p>Hold the programming card No. 1 (P1: Mode) in front of the reader. “Shared use” mode is selected.</p>	<p>Shared use</p> 	
 <p>Hold the programming card No. 1 (P1: Mode) in front of the reader again. “Assigned use” mode is selected.</p>	<p>Assigned use</p> 	
 <p>Hold the master card in front of the reader.</p>		

DEACTIVATING AND ACTIVATING ACOUSTIC SIGNALS

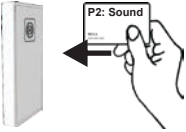
Acoustic signalling is activated when the system is delivered. You have the option of deactivating the acoustic signals with the aid of the master card and the programming card No. 2 (P2: Sound). For this, the lock must be open. It is recommended that the acoustic signals should only be deactivated if the RFID reader with the LED is mounted outside the item of furniture. Otherwise, neither visual nor acoustic signals are passed on to the users, making programming and possibly also operation difficult.

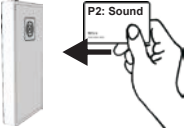
Please note that the acoustic signals for the battery warning and for changing the operating mode cannot be deactivated.

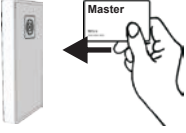





The programming card set must be bought separately from LEHMANN Vertriebsgesellschaft mbH & Co. KG. The cards are for universal use.

Deactivating and activating acoustic signals	
 <p>Hold the master card in front of the reader.</p>	
 <p>Hold the programming card No. 2 (P2: Sound) in front of the reader. The acoustic signals are deactivated.</p>	<p>Acoustic signals are deactivated.</p> 
 <p>Hold the programming card No. 2 (P2: Sound) in front of the reader again. Acoustic signals are activated again.</p>	<p>Acoustic signals are activated.</p> 
 <p>Hold the master card in front of the reader.</p>	

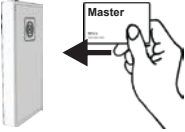
RESETTING TO FACTORY SETTINGS (RESET)

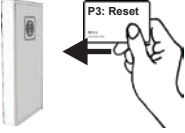
If a reset to factory settings is required, all master and user cards are deleted. With an installation card the basic functions (close and open) can be carried out. The bolt is retracted, and the lock must be reprogrammed with a master card.

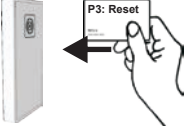

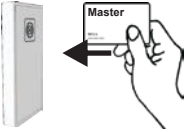
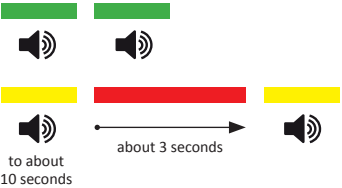
The reset function can be used with the help of the master card and programming card No. 3 (P3: Reset). For this, the lock must be open. The programming card set must be bought separately from LEHMANN Vertriebsgesellschaft mbH & Co. KG. The cards are for universal use.





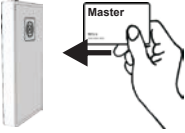

Resetting to factory settings	
 <p>Hold the master card in front of the reader.</p>	
 <p>Hold the programming card No. 3 (P3: Reset) in front of the reader.</p>	
 <p>Hold the programming card No. 3 (P3: Reset) in front of the reader again.</p>	
 <p>Hold the master card in front of the reader. During initialisation, no transponders should be placed within the read range of the RFID reader.</p>	

ACTIVATION AND DEACTIVATION OF AUTOMATIC LOCKING

With the programming card „P4: Auto Locking“, the function „automatic locking“ can be activated and deactivated in the operating mode „assigned use“. Once the function is activated, the lock closes automatically after 5 seconds after opening the lock with an authorized transponder. This function is only suitable for locks with a spring loaded bolt. It is recommended to activate „automatic locking“ after programming the transponders. The lock must be in open position and in mode assigned use in order to activate this function. If the operating mode is changed, this function is automatically deactivated. The programming card must be purchased separately from LEHMANN Vertriebsgesellschaft mbH & Co. KG. The card can be used universally. Firmware version 1.0.10 or higher is required on the RFID reader for this function.

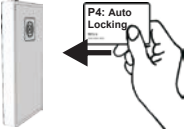
NOTE: If the function „automatic locking“ is activated, hold the master card in front of the RFID reader immediately after opening in order to start the programming. Otherwise, the lock will lock automatically after 5 seconds. The lock must be in an open position for programming incl. programming user cards.

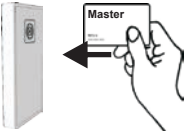
Activate or deactivate the feature automatic locking	
 <p>Hold the master card in front of the reader.</p>	





 <p>Hold the programming card „P4: Auto Locking“ in front of the lock. Automatic locking is activated.</p>	<p>Automatic locking is activated.</p> 
 <p>Hold the programming card „P4: Auto Locking“ in front of the lock. Automatic locking is deactivated.</p>	<p>Automatic locking is deactivated.</p> 
 <p>Hold the master card in front of the reader.</p>	

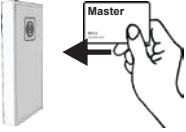

ACTIVATION AND DEACTIVATION OF UNLIMITED SHARED USE

With the master card and the „P6: Unlimited Shared Use“ programming card, the function can be activated and deactivated in the „shared use“ mode. After activation, an RFID transponder can lock several locks at the same time (caution: even up to all locks!), instead of just one lock per transponder in this operating mode. To activate and deactivate the function, the lock must be in an open position. The configuration process is the same process as the activation and deactivation of the auto locking function (see page 15).

CONFIGURE RFID SYSTEM WITH LEGIC SYSTEM AUTHORIZATION MEDIA (SAM)

Special permissions and configurations are transferred to the RFID reader by using the SAM 63 card that is part of the LEGIC Master-Token System-Control (MTSC). Following this, only LEGIC advant transponders or user cards with the associated digital stamp can be used on the RFID readers. Master and programming cards are still usable. The lock must be open in order to program the SAM 63 card. Detailed information about the LEGIC MTSC is available at www.legic.com.

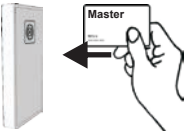





Configuration with LEGIC SAM 63 card	
 <p>Hold the master card in front of the reader.</p>	
 <p>Hold the LEGIC SAM 63 card in front of the reader.</p>	

 <p>Hold the master card in front of the reader.</p>	
---------------------------------------------------------------------------------------------------------------------------------------	-----------------------------------------------------------------------------------

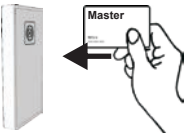
If the lock is in delivery state (no master card programmed), you can hold the card LEGIC SAM 63 directly in front of the RFID reader for configuration without a master card.

REMOVE LEGIC MTSC CONFIGURATION ON RFID SYSTEM

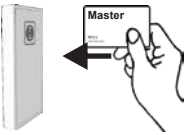
With the SAM 64 (System Authorization Media) card, which is part of the LEGIC MTSC (Master-Token System-Control), the previously created authorizations and configurations by using the SAM 63 card are deleted again in the RFID reader. Following that, all types of transponders mentioned on page 2 under technical specifications can be used again. The lock must be open when using the SAM 64 card.

Remove configuration with LEGIC SAM 64 card	
 <p>Hold the master card in front of the reader.</p>	
 <p>Hold the LEGIC SAM 64 card in front of the reader.</p>	
 <p>Hold the master card in front of the reader.</p>	

BATTERY WARNING

The locking system is equipped with a battery management system which uses visual and acoustic signals to indicate the need for battery replacement in the event of reduced battery power. The battery warning takes place in two phases:

Battery warning Phase 1	
<p>Before an action can be carried out (closing / opening / programming), a battery warning is given. The battery should be replaced.</p> <p>The battery warning is also given every 60 minutes.</p>	

Battery warning Phase 2

The lock can only be opened. Before the lock opens, a battery warning is given. The battery must be replaced without delay.

The battery warning is also given every 60 minutes.



The settings are saved even without a power supply (e.g. in case of battery replacement, or in case the battery should be completely empty). Battery replacement should be carried out within 5 minutes.

EMERGENCY POWER SUPPLY

If the battery are completely discharged and you cannot reach the battery compartment inside the furniture, you still have the option of obtaining an emergency power supply if you have an external RFID reader. To do this, you can use a standard power bank (additional rechargeable battery) with a USB port complying with the USB 2.0 standard. A micro USB Type B connector is required for the emergency power supply of the RFID reader. Use the emergency power supply only for a short period of time for the one-off opening of a lock. Before use, it is essential that you should read the operating instructions of the power bank. Please proceed as follows:

- First remove the protective rubber cap on the micro USB port on the underside of the RFID reader.
- Connect the charged power bank to the RFID reader using the micro USB port.
- Please take account of the operating instructions of the power bank, e.g. for starting and ending the charging process.
- Please do not perform any further actions until the RFID reader gives an acoustic and a visual signal (see Acoustic and visual signals when inserting the battery).
- Then open the lock with an authorised transponder card. Here you can use either a programmed user card or the master card for emergency opening.
- Then carefully disconnect the power bank from the RFID reader.
- Replace the protective rubber cap on the micro-USB port of the RFID reader.
- Replace the battery in the lock (see Getting started and changing battery).
- Perform a function test (opening and closing) while the furniture is open.

RFID reader L043-A01

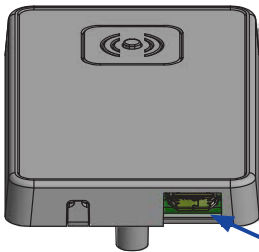

RFID reader L043-A02



Micro USB port for emergency power supply and firmware updates

CAUTION: Emergency power supply is only possible if the RFID reader is mounted externally!

FIRMWARE UPDATE

You have the option of updating the firmware of the lock and the RFID reader via the micro USB ports on the lock or the RFID reader. Firmware updates are provided only when needed (for example, technical need).

To update the firmware you need the software LEHMANN Firmware Updater. The software can be found on the website www.lehmann-locks.com under Electronic Locking Systems and there under Software Solutions.

The individual steps for updating the firmware are described in the software.

REORDERING MASTER CARDS







With this locking system, you have the option of ordering replacements for your master cards at your own expense. For this you obtained a service key together with the master cards. Please keep the service key carefully and securely. The service key makes it possible to reorder the master card specified there.

To reorder these cards, please contact LEHMANN Vertriebsgesellschaft mbH & Co. KG at the following email address: sales@lehmann-locks.com

In your email, please give us your contact data and the service key. In your email, please also state the number of replacement cards you require.

TROUBLESHOOTING

In the following overview you can see the acoustic and visual signals that indicate faults:

	<p>Transponder card cannot be programmed.</p>	<p>Possible reasons:</p> <ul style="list-style-type: none"> • Storage space is used up • Card is not compatible • Master card has not yet been programmed
	<p>Available storage space in the lock is used up.</p>	<p>Possible reasons:</p> <ul style="list-style-type: none"> • 50 user cards have already been programmed in the lock.
	<p>Bolt warning: the bolt does not move to the end position.</p>	<p>Possible reasons:</p> <ul style="list-style-type: none"> • Striker plate or lock not correctly installed. • Furniture door is not closed. • The bolt is being blocked by an object.
	<p>Battery warning Phase 1</p>	<p>It is recommended that you replace the battery.</p>
	<p>Battery warning Phase 2</p>	<p>The battery must be replaced without delay.</p>
	<p>Communication error between the RFID reader and the lock</p>	<p>Possible reason:</p> <ul style="list-style-type: none"> • Connecting cable between the lock and the RFID reader is not correctly connected.

continue on page 20

For further recommendations on how to eliminate possible faults, you can also refer to the following table:

<p>Reading range is low</p>	<ul style="list-style-type: none"> • Move the transponder card slowly and directly centred in front of the RFID reader. • Check and if necessary replace the battery. • Test the reading range with the supplied master card. • Test the reading range with a second user card.
<p>Lock does not respond to user card</p>	<ul style="list-style-type: none"> • Check whether the lock reacts to the supplied master card (if necessary, follow the programming process for master cards). • Program a new and suitable user card according to the operating instructions. • If necessary, perform an emergency opening in accordance with the operating instructions and check the functions (open/close) with an authorised user card again when the furniture is open. If the lock should work properly, please check to see if the bolt can extend correctly when the furniture is closed (see installation recommendation). • If you are using an existing user card (not from the Lehmann company), check to see whether the appropriate write permission has been given for the transponder card.
<p>Lock and reader do not react</p>	<ul style="list-style-type: none"> • Check that the battery have been inserted correctly. • Check to see whether the reader is correctly connected to the lock. • Use the supplied master card and follow the operating instructions for programming the master card.
<p>Only one user card can be programmed</p>	<ul style="list-style-type: none"> • Check the selected operating mode and change it if necessary to “Assigned use”.
<p>Only one master card can be programmed</p>	<ul style="list-style-type: none"> • This is correct and is an integral part of the safety concept. You have the option of choosing a replacement master card.

LEHMANN Vertriebsgesellschaft mbH & Co. KG
 Postfach 26 20 • D-32383 Minden
 Fon +49 571/50 599-0 • Fax +49 571/50 599-822
info@lehmann-locks.com • www.lehmann-locks.com
 DIN EN ISO 9001:2008 zertifiziert